

7UHQFK 026 %DUULHU 6FKRWWN\ 5H

### Features

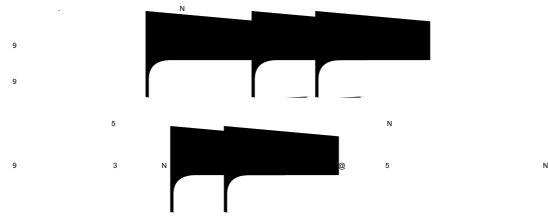

### Applications

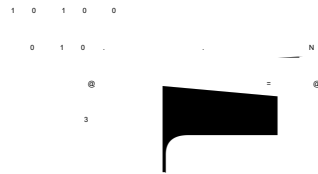

Maximum ratings and electrical characteristics (TJ = 25°C unless otherwise noted)

--	--	--	--	--	--	--	--	--	--

3XOVH WHVW 3XOVH ZLGWK GXW\ F\FOH  
 3XOVH WHVW 3XOVH ZLGWK 0

RATINGS AND CHARACTERISTICS CURVES 7\$

f & XQOHVQRWKB UZLVH

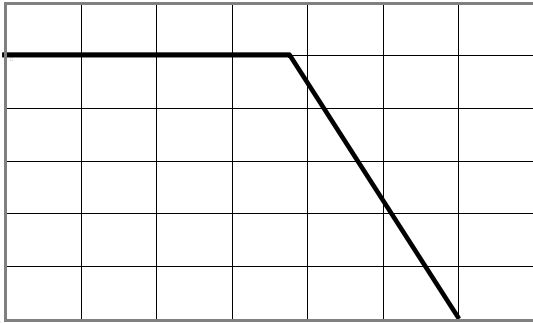

Current Derating, Case

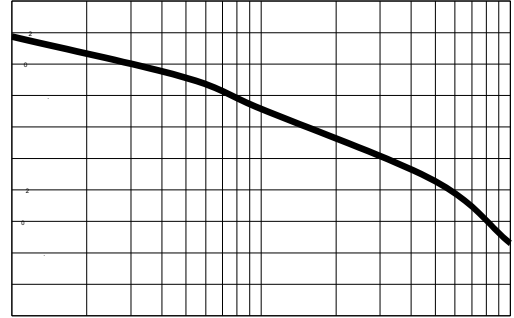

Maximum Repetitive Surge Current

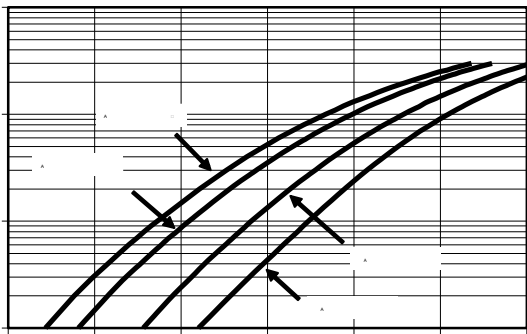

Typical Forward Voltage

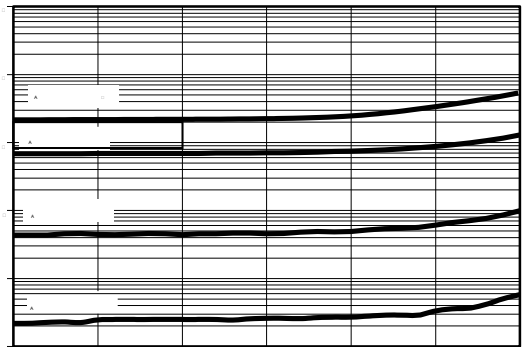

Typical Reverse Current

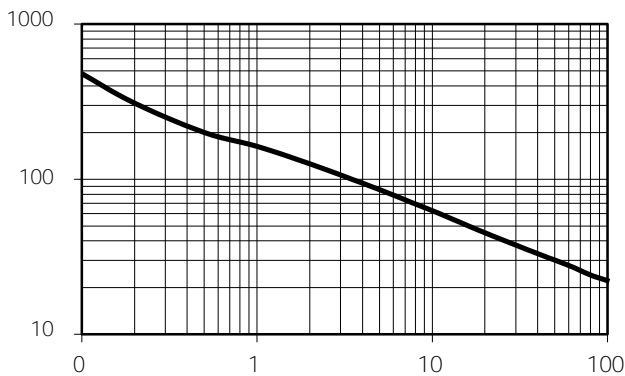

Typical Junction Capacitance

## PACKAGE OUTLINE DIMENSIONS

### SMP6

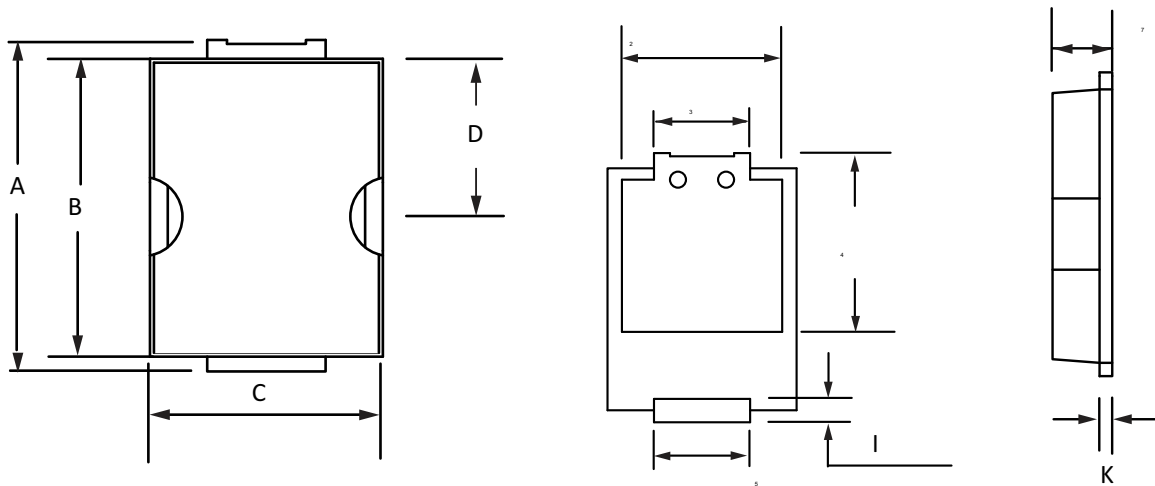

### SMP6 mechanical data

A	B	C	D	1	2	3	4	5	6	7	K

### SMP6 Suggested Pad Layout

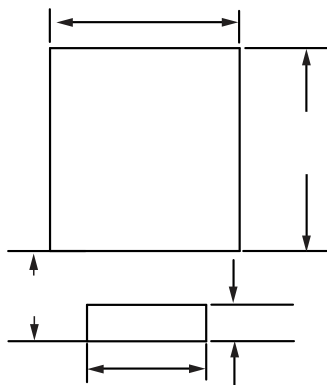

A	B	C	D	1	2	3	4	5	6	7	K