

TO-220AB  
TSR 6 CT

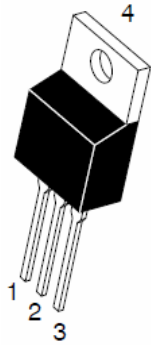

ITO-220AB  
TSR 6 CTF

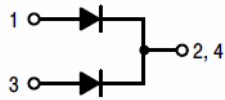
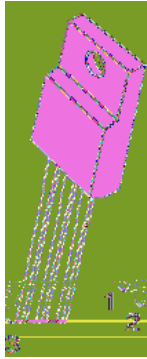

### Features

- ‡ \$GYDQWUHQFK WHFKQRORJ\
- ‡ /RZRUZDYGWDJH GURS
- ‡ /RZRZURVVHV
- ‡ +LJKILFLHQF\ RSHUDWLRO
- ‡ /HDGH)HLQLVK &RPSOLDQW

RATINGS AND CHARACTERISTICS CURVES 7\$ f & X Q O H V Q R W K B U Z L V H

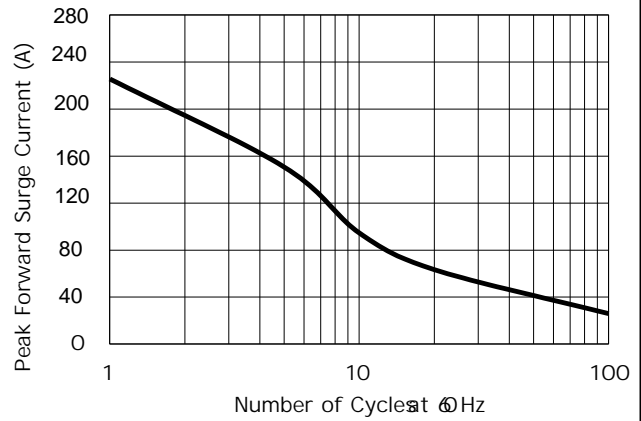
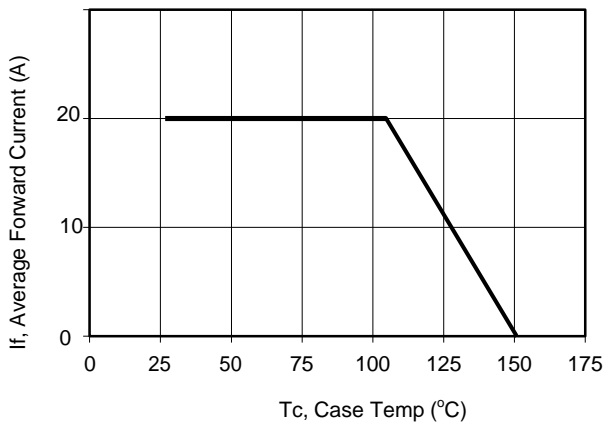

Current Derating, Case

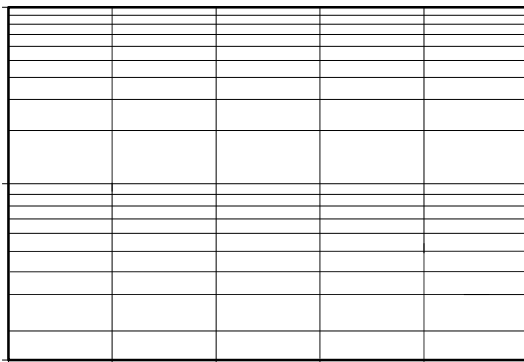

Maximum Repetitive Surge Current

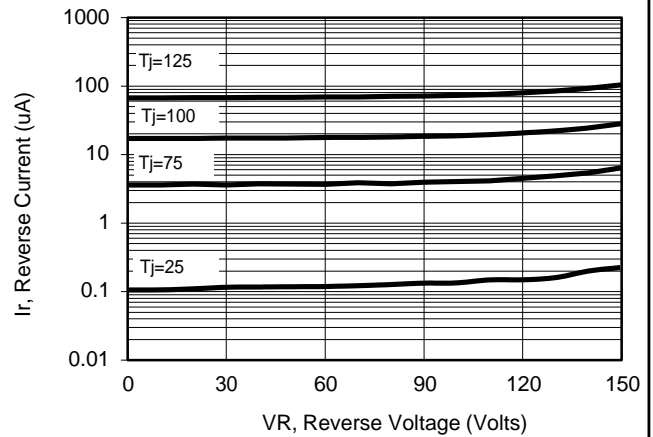

Typical Reverse Current

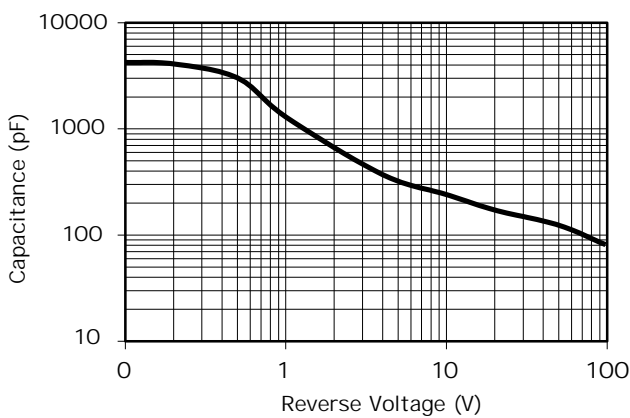

Typical Junction Capacitance

# PACKAGE OUTLINE DIMENSIONS

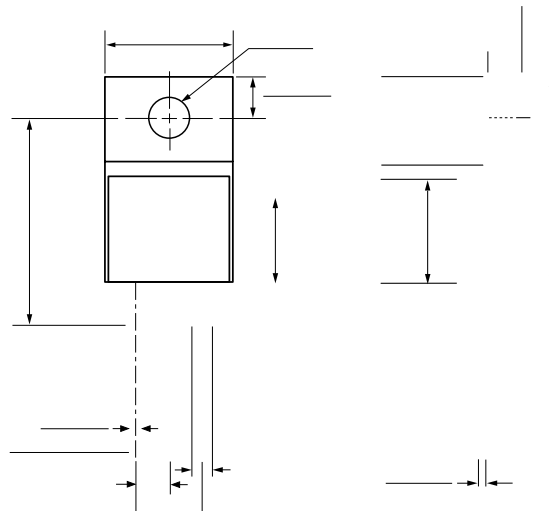

**Marking Information**

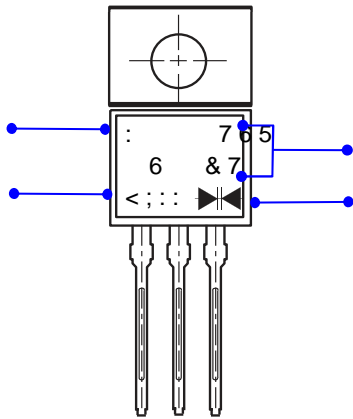

3URGXFW 765GH60 & 7 RU 765 & 7)  
3' & LQIRUPDWLRQ

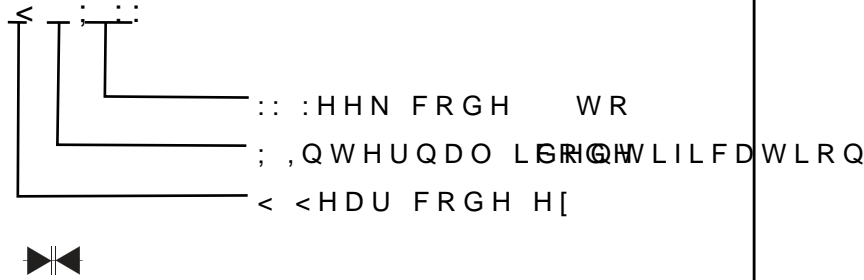

**Packaging Information**

7XEH 'LPHQVLRQV

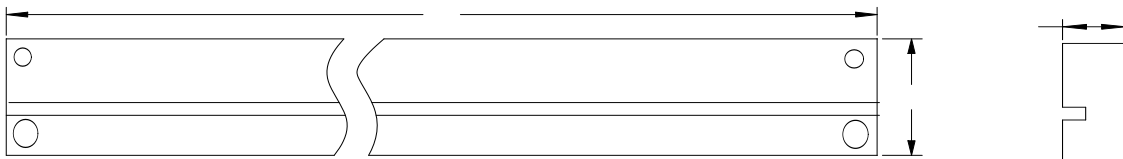

,QVLGH %R[

2XWVLGH %R[

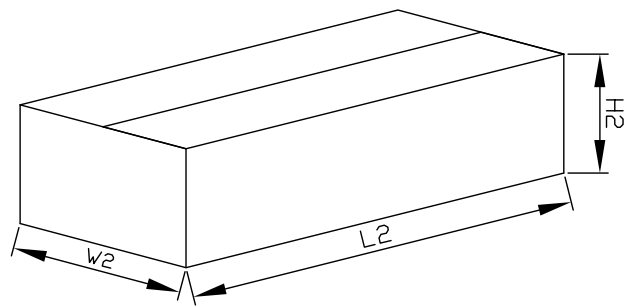
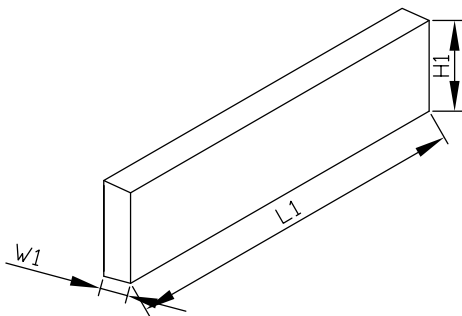

**Packaging Information**

12	81,	7XEH 'LPHQVLRQV			,QVLGH %R[			2XWVLGH %R[		
6L]H	PP	\$	%	&	/	:	+	/	:	+
47<	3&6	3&6 7XEH			6PDO SHVWDJH3&6 WXEWRWDO			3&6 FDUERGLWRWDO		
1RWH	7ROHUDQFHPP"PP			PP"PP			PP"PP			